

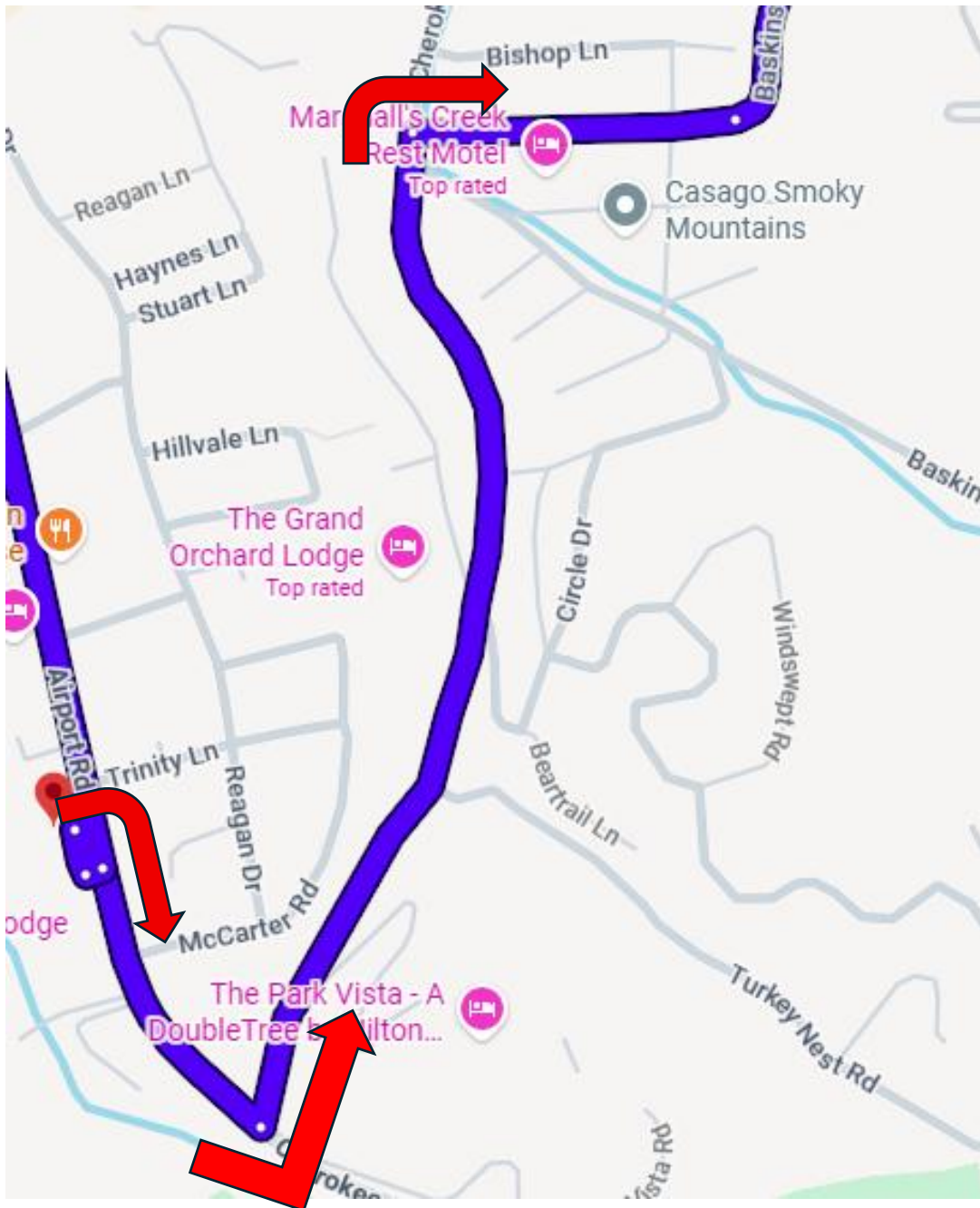

Tail of the Dragon via Foothills Pkwy

(Approximately 150 miles)



• ***** BYPASS DOWNTOWN GATLINBURG *****

- **RIGHT** turn out of Glenstone Lodge
- **CONTINUE** approximately 0.25 miles
- **LEFT** turn onto Cherokee Orchard Rd
- **CONTINUE** on Cherokee Orchard Rd for approximately 0.7 miles
- **RIGHT** turn onto Newton Ln / Baskin Creek Bypass
- **CONTINUE** on Newton Ln / Baskin Creek Bypass to East Pkwy /Hwy 73 / US 321 for approximately 0.7 miles

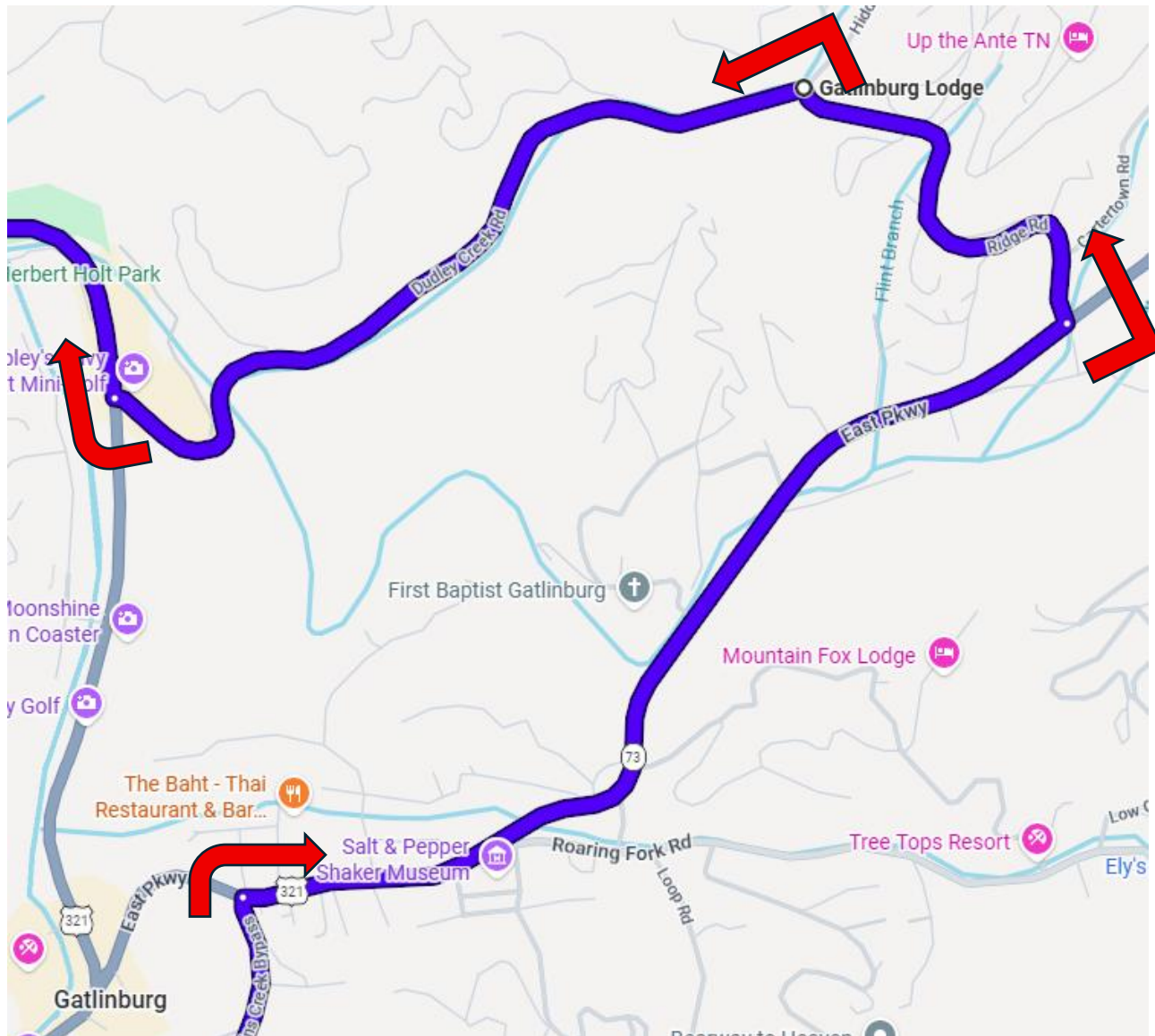

- **CONTINUE** on East Pkwy / Hwy 73 / US 321 Blue Ridge Pkwy for approximately 1.2 miles to Ridge Rd
- **LEFT** onto Ridge Rd
- **CONTINUE** on Ridge Rd for approximately 0.5 miles
- **LEFT** onto Dudley Creek Rd
- **CONTINUE** on Dudley Creek Rd approximately 1 mile to Great Smoky Mtns Pkwy / US 321 / US 441
- **RIGHT** onto Great Smoky Mtns Pkwy / US 321 / US 441
- **Continue** approximately 4.5 miles on Great Smoky Mtns Pkwy / US 321 / US 441

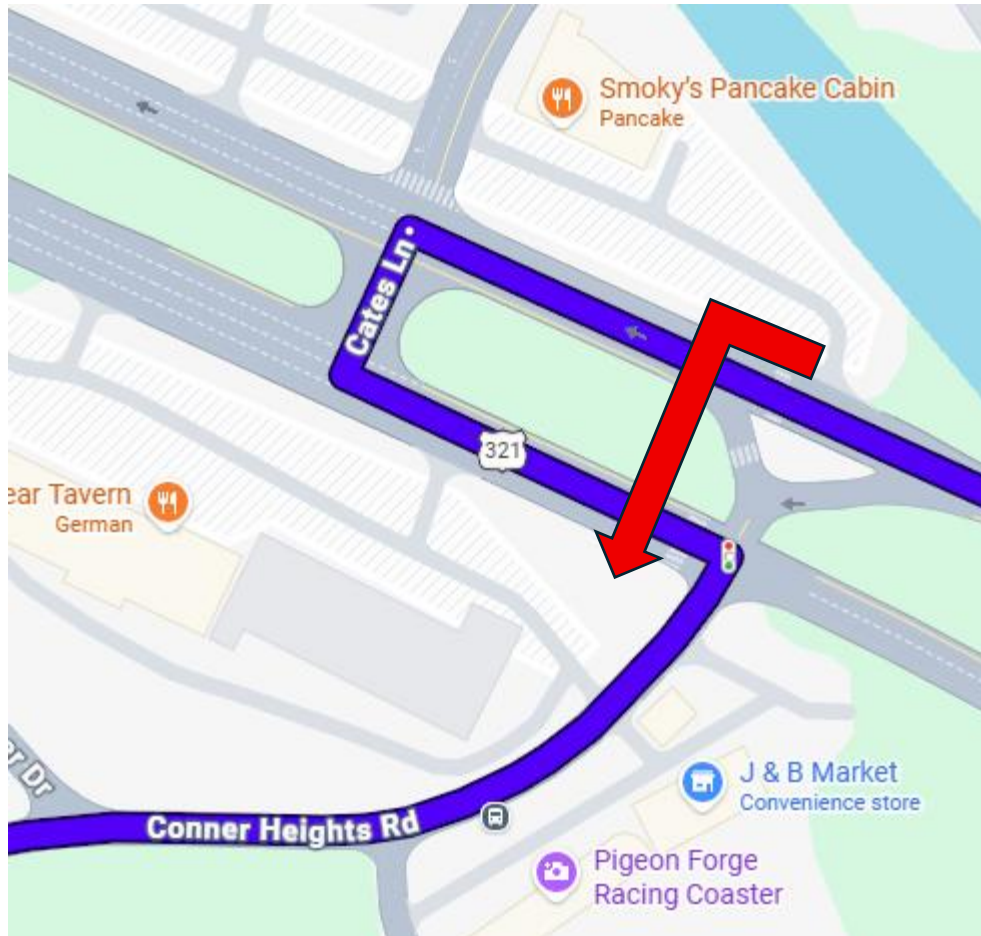

- **LEFT** onto Conner Heights Rd / Mill Creek Rd
- **CONTINUE** on Mill Creek Rd for approximately 1.7miles
- **ROAD NAME CHANGES** to Little Cove Rd
- **Continue** on Little Cove Rd for approximately 4.5 miles to Valley View Rd / Bryan Rd

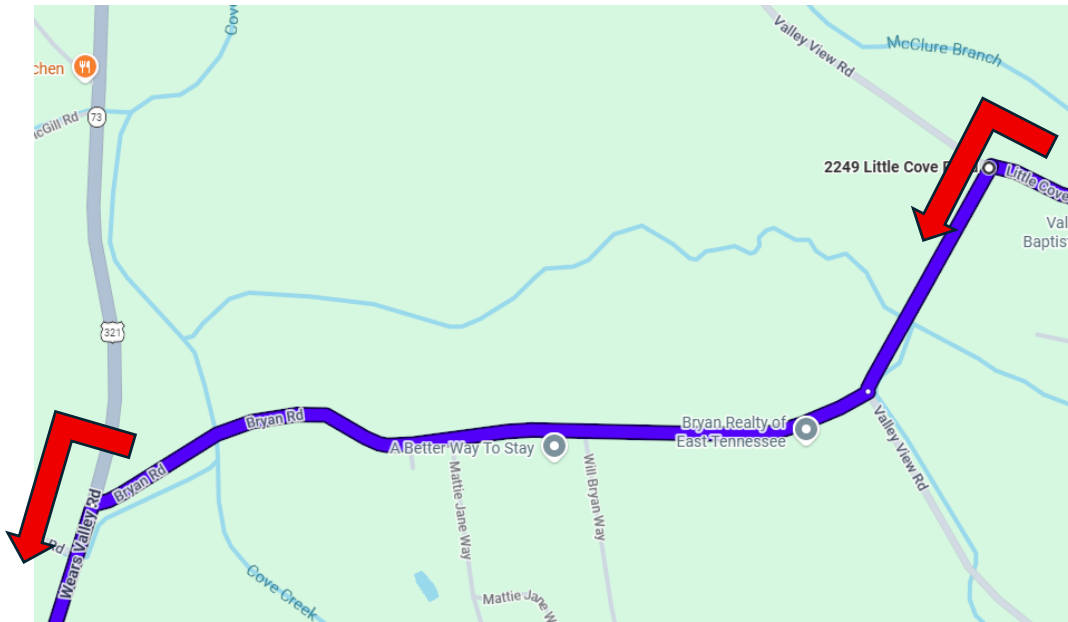

- **LEFT** onto Valley View Rd / Bryan Rd
- **LEFT** onto Hwy 73 / US 321 / Wears Valley Rd
- **CONTINUE** on Hwy 73 / US 321 / Wears Valley Rd for approximately 1.2 miles

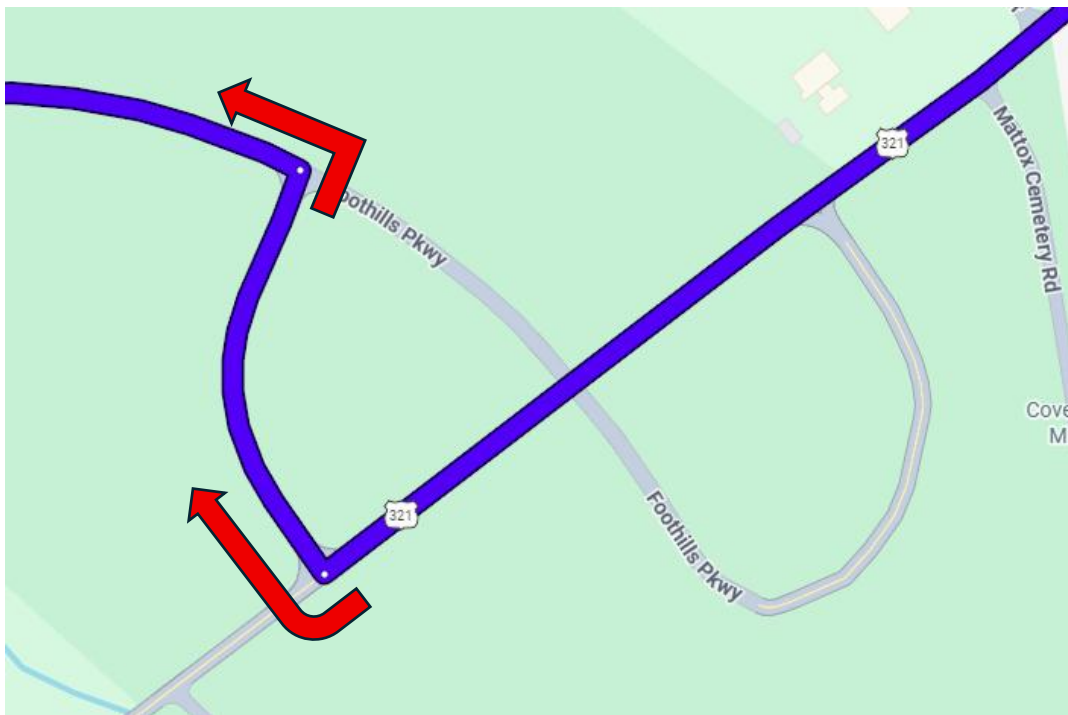

- **RIGHT** onto Foothills Pkwy access ramp
- **LEFT** onto Foothills Pkwy
- **CONTINUE** on Foothills Pkwy for approximately 31 miles

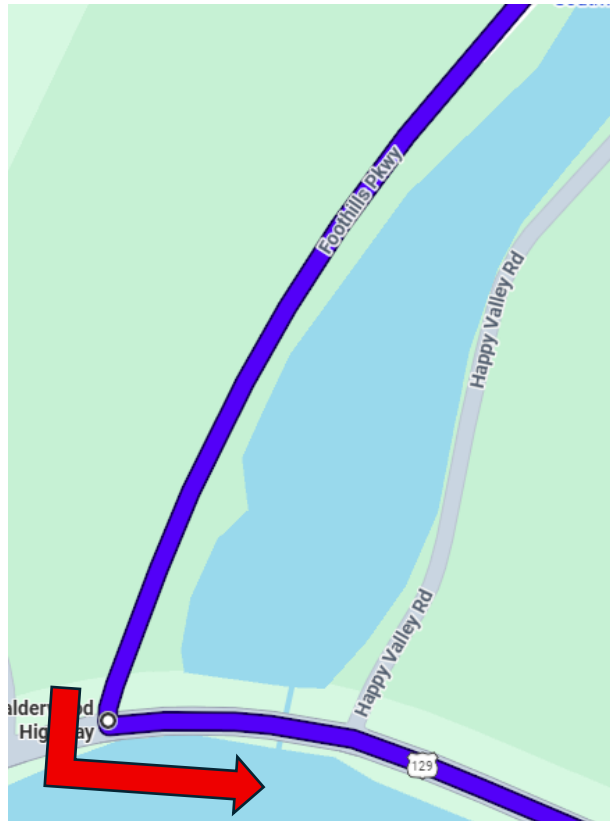

- **LEFT** onto US 129 (The Dragon)
- **CONTINUE** on US 129 approximately 15 miles to Deals Gap



- **LEFT** onto Hwy 28
- **CONTINUE** on Hwy 28 for approx 10.5 miles to Fontana Dam Rd



- **LEFT** onto Fontana Dam Rd
- **CONTINUE** on Fontana Dam Rd approximately 1 mile to visitor center
- **EXIT** visitor center
- **LEFT** onto Hwy 28 towards Stecoah
- **US 74** eventually merges onto Hwy 28
- **CONTINUE** on Hwy 28 / US 74 approximately 39 miles towards Cherokee, NC

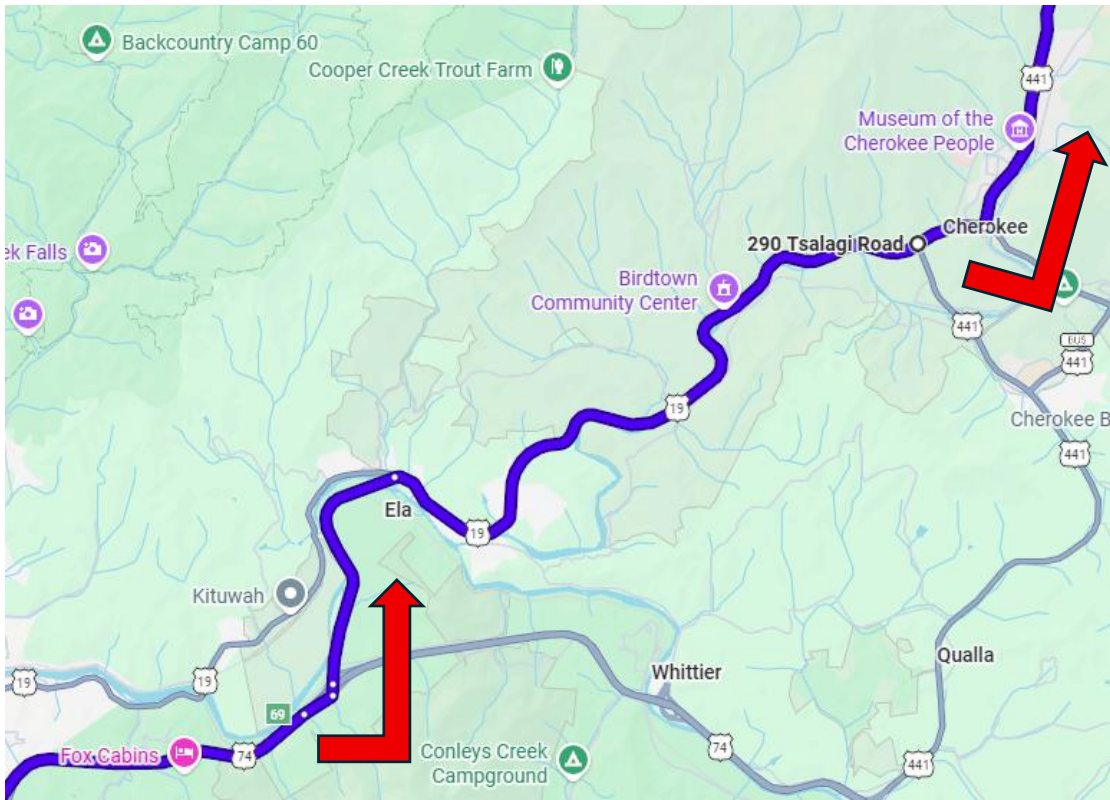

- Go past Bryson City
- LEFT onto US 19 towards Cherokee, NC
- LEFT onto US 441 towards Gatlinburg / Smoky Mtns Natl Park
- CONTINUE on US 441 to Gatlinburg

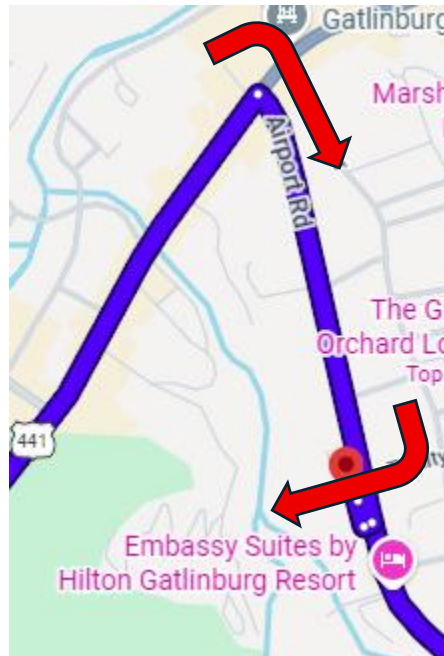

- RIGHT onto Airport Rd
- RIGHT into Glenstone Lodge